

# KV GSlide® GS4205 Over Travel Drawer Slide



## Features

- 1" over travel for full access to drawer contents
- 32mm hole pattern
- Lever disconnect for easy drawer removal
- Hold-in detent
- Non-handed design
- Recommended maximum drawer width 24"

**Mounting:** Side

**Action:** Telescopic movement on ball-bearings

**Load Rating:** 90 lb. class

**Height:** 1.79" [45.5mm]

**Clearance:** .50" + .03" - 0" on each side

**Finish:** Zinc (ZC), Black (EB)

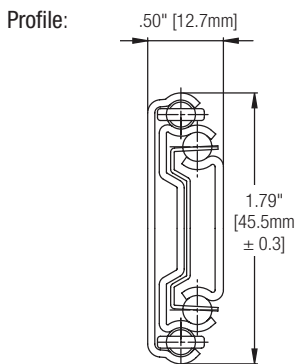

## Mounting Brackets

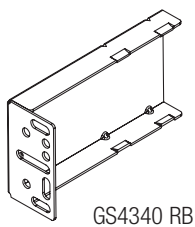

Product	Front or Rear	Finish	Pack
GS4340 RB	Rear	Zinc (ZC)	200

## Configurations

Bulk (B)	10 Pair and 1 set of instructions per box without screws
<b>GS4205 Zinc (ZC) Finish</b>	
<b>Size</b>	<b>Bulk (B)</b>
250mm	GS4205 10
300mm	GS4205 12
350mm	GS4205 14
400mm	GS4205 16
450mm	GS4205 18
500mm	GS4205 20
550mm	GS4205 22
600mm	GS4205 24
650mm	GS4205 26
700mm	GS4205 28
<b>GS4205 Black (EB) Finish</b>	
250mm	GS4205 EB 10
300mm	GS4205 EB 12
350mm	GS4205 EB 14
400mm	GS4205 EB 16
450mm	GS4205 EB 18
500mm	GS4205 EB 20
550mm	GS4205 EB 22
600mm	GS4205 EB 24
650mm	GS4205 EB 26
700mm	GS4205 EB 28

Recommended Fasteners	KV Part	Finish	Qty
 #7 x 1/2" Phillips Pan Head	8500-93	Zinc (ZC)	1000
	8500-93 EB	Ebony Black (EB)	1000