



5500D17

Encore Arm

Standard Length

This entry level arm provides most of the features available on our main family of arms but at an economy price point.

5500 series

| Features | Benefits |
|-------------------------------------|---|
| Low profile design | Provides maximum leg room |
| Economy ergonomic keyboard solution | Cost effective price point |
| Star wheel adjustment knob | Simultaneous height and tilt adjustment |
| 360° swivel | User can move freely from side to side |
| Meets ANSI/BIFMA standards | Quality assured manufacturing |
| Stores on plastic glide track | Frees up space in front of desk |

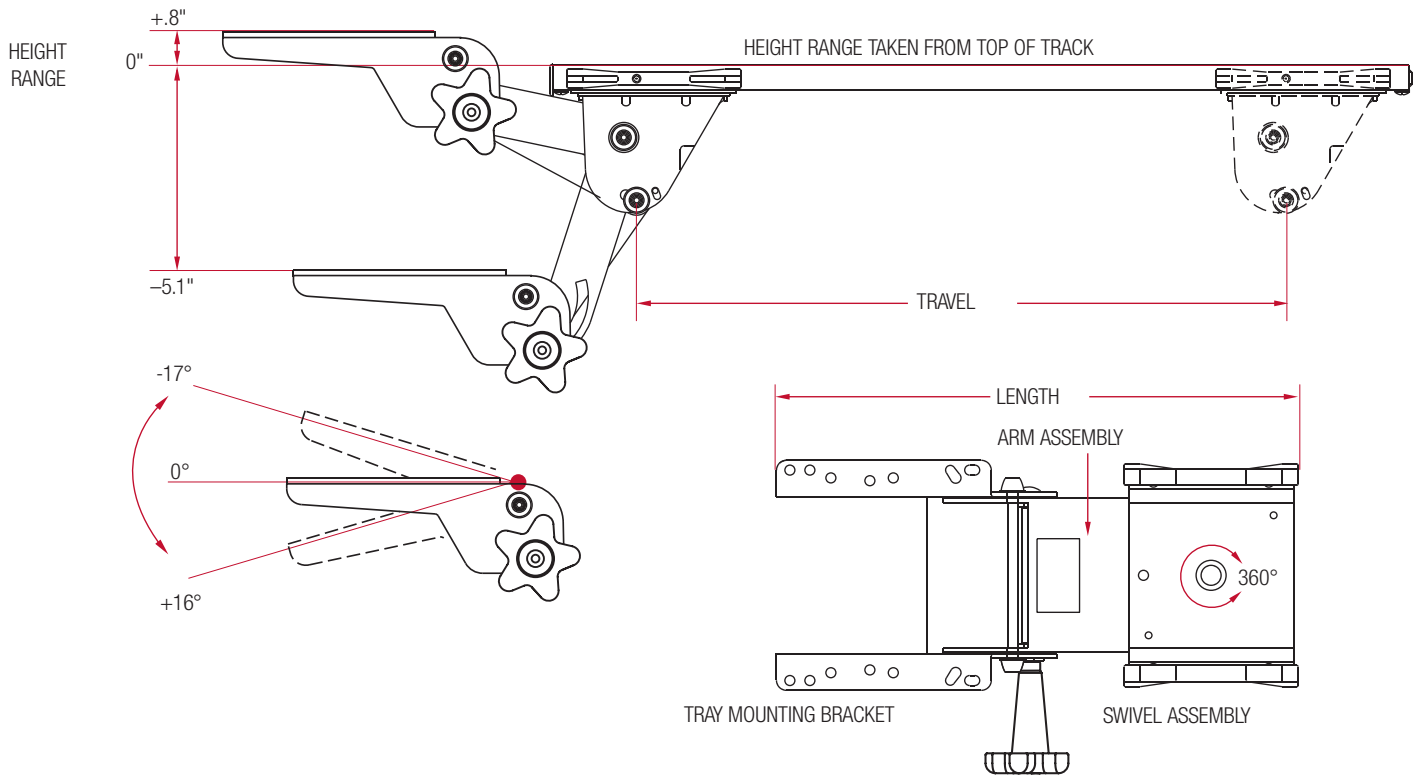

Encore Arm 5500 series

Ancillary Products:

- Encore Arm is an ideal complement to most Knape & Vogt Waterloo keyboard trays
- Use with Knape & Vogt Waterloo CPU holders
- For flat panel displays, specify the Concerto flat panel support system

| Model | Height Range | Tilt | Length | Travel | Track Size | Track Style | Weight |
|---------|--------------|-----------|--------|--------|------------|---------------|---------|
| 5500D17 | +.8"/-5.1" | +16°/-17° | 14.5" | 11.9" | 17.0" | plastic glide | 6.0 lbs |

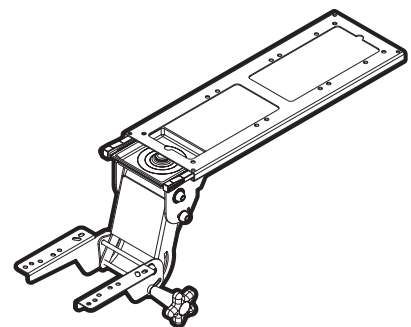

Black



Code Compliance: Meets ANSI/BIFMA standards

Notes: 1. Weight = packaged shipping weight per unit. 2. Specifications are subject to change without notice.



2700 Oak Industrial Dr. NE
Grand Rapids, MI 49505-6026 USA
1.800.253.1561 | 616.459.3311
Fax: 877.636.3290
www.kv.com

This and other KV literature is available for download at www.kv.com > Resource Library

Knape & Vogt reserves the right to change product specifications at any time without notice and without incurring responsibility for existing units.
©2017 Knape & Vogt. KV and the KV logo are trademarks of Knape & Vogt.

OL2549/0717