

Box Drawer Slides

Market Need:

- Access to small office supplies (Stapler, pens, paper clips etc.) 3" – 6" tall drawers with up to 75 lbs. weight load

Design Challenges:

- Access to drawer content
- Effective closure
- Simple attachment methods
- Smooth and quiet operation

KV Solution:

Sliding system that is right-sized for the application. Slide features incorporated into a design like this include:

- Slide travel from partial to over-travel
- Hold in detent
- Wood hole pattern or metal attachment features
- Bumpers and stops to reduce noise
- Soft-close or push to open mechanisms
- Black or Zinc finish

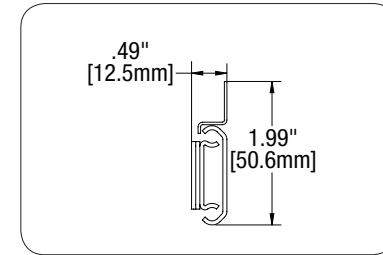

- 50.6mm (1.99") tall
- 2 member partial extension
- 12.5mm (.49") wide

[Download Profile](#)

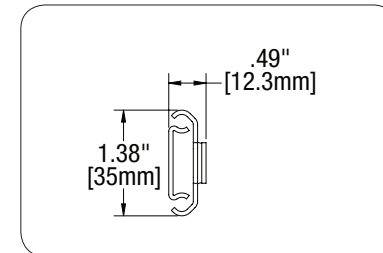

- 35mm (1.38") tall
- 2 member partial extension
- 12.3mm (.49") wide

[Download Profile](#)

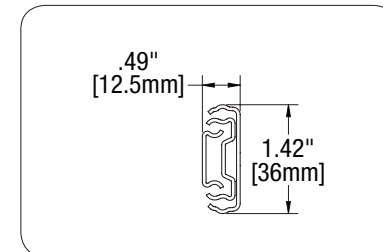

- 36mm (1.42") tall
- 3 member full to over extension
- 12.5mm (.49") wide

[Download Profile](#)



KNAPE & VOGT®